

# PRODUCT SUBMITTAL

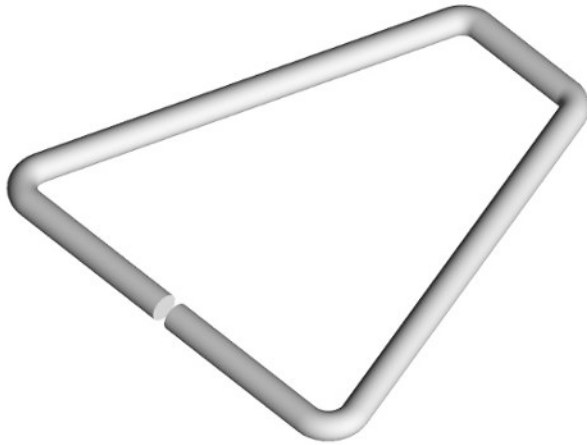

## # 1100 Triangular



The #1100 Triangle is used in conjunction with the Type III Screw-On Veneer Anchor for anchoring brick veneer to metal stud.

Brick Institute of America and ACI 530 do not recommend ties with formed drips. Tests have shown that drips can reduce the ultimate buckling load by approximately 50%.

MATERIAL CONFORMANCE	SIZES / FINISHES	
<p><b>ASTM A82 / A82M</b> - (Cold drawn steel wire) Tensile Strength - 80,000 psi Yield Point - 70,000 psi</p> <p><b>ACI / ASCE 530</b> - (Building code requirements for masonry structures)</p> <p>Mill Galvanized / Zinc Coating: <b>ASTM A641 / A641M (0.10 oz per sq ft)</b> Hot Dip Galvanized after fabrication / Zinc Coating <b>ASTM A153 / A153M-B2 (1.50 oz per sq ft)</b> Stainless Steel <b>ASTM 580 / ASTM 580M Type 304</b> (Type 316 available on special order)</p> <p><b>WIRE Recycled Content:</b> Mill Galvanized &amp; Hot Dip, 85% Post-Consumer 13% Post Industrial / Pre - Consumer</p> <p>Stainless Steel, 60% Post Consumer V O C Content - 0%</p> 	<p><b># 1100 Triangle Diameter:</b></p> <p><input type="checkbox"/> 3/16"Ø <input type="checkbox"/> 1/4"Ø</p> <p><b># WIRE BOND Clip:</b> 16 gauge</p> <p><b>Finishes:</b></p> <p><input type="checkbox"/> Mill Galvanized    <input type="checkbox"/> Hot Dip Galvanized    <input type="checkbox"/> Stainless Steel</p>	<p><b># 1100 Triangle Size:</b></p> <p><input type="checkbox"/> 3" x 3"    <input type="checkbox"/> 6" x 6" <input type="checkbox"/> 4" x 4"    <input type="checkbox"/> 7" x 7" <input type="checkbox"/> 5" x 5"    <input type="checkbox"/> 7" x 9" <input type="checkbox"/> Other _____</p> <p><b>Straight &amp; Cut Seismic Wire:</b> 10'-0" Lengths <input type="checkbox"/> 9 gauge    <input type="checkbox"/> 3/16" diameter</p>

**Corporate Office:** 400 Roundtree Rd Charlotte, NC 28217  
TEL: (800) 849-6722 FAX: (704) 525-3761

**Mailing Address:** P.O. Box 240988 Charlotte, NC 28224



[www.wirebond.com](http://www.wirebond.com)

**Memphis Plant:** 2365 Harbor Ave. Memphis, TN 38113  
TEL: (800) 441-8359 FAX: (901) 775-9449

**Mailing Address:** P.O. Box 13124 Memphis, TN 38113