



1 Trash Mortar Diverter™

TMD 9548

Works because:

- Its V-shaped design stops, holds, and encapsulates trash mortar.
- Its V-shaped design funnels moisture to the center and bottom of cavity and weep systems.
- Trash mortar is caught before it plugs the weeps.
- It can be used in cavities with 1.5" to 3" air space.
- It's easy to install — lightweight, but not fluffy, 4' pieces slide right in.
- Recycled material is inexpensive, readily available and provides a positive environmental impact.
- Prevents mortar bridging.

Installation:

1. Insert Trash Mortar Diverter into cavity with "V" pointed in downward position with short edge to outside of building.
2. Place Trash Mortar Diverter in a "Checkerboard", "Stair Step" or Architect/Engineer-recommended pattern.

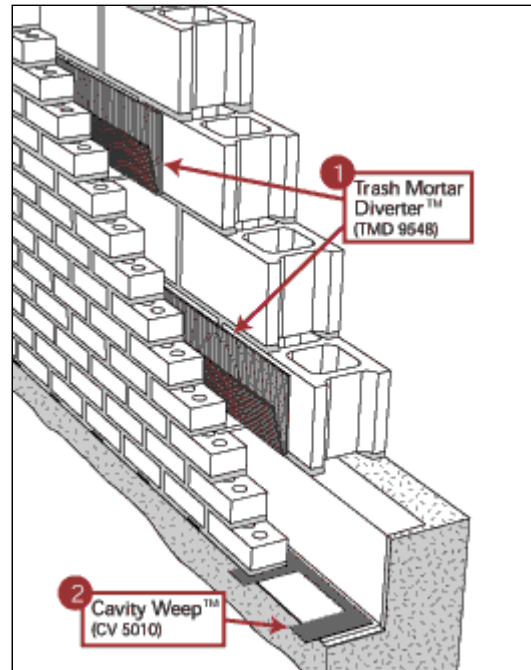

Ordering and Shipping Information

Bundle Contains	Box Contains	Pallet Contains
4 Rolls of Trash Mortar Diverter (4' x 10') = 40 linear ft.	6 bundles/box/240 linear ft	10 boxes/pallet/2400 linear ft.

Close This Window

Print This Page

Copyright 2007 Masonry Technology, Inc.