

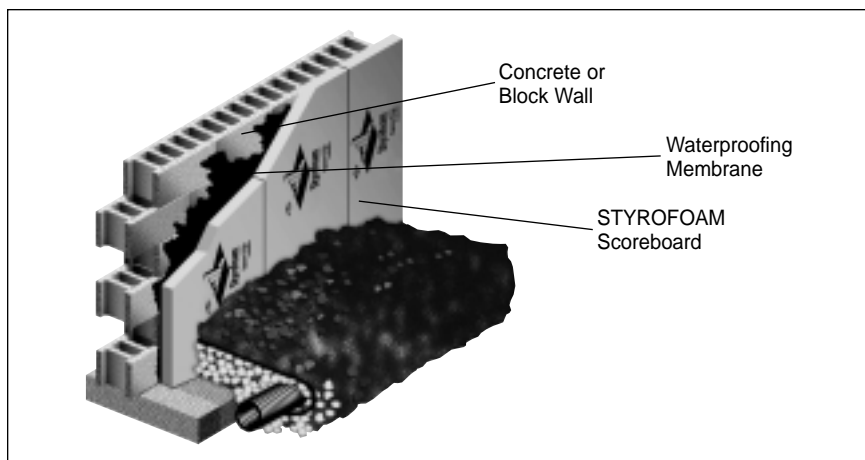

# STYROFOAM Brand Scoreboard

## Scoreboard Insulation

STYROFOAM\* Brand Scoreboard Insulation is a closed cell extruded polystyrene foam designed for use in roof, wall and foundation insulation applications. The 48" x 96" boards are scored in the long dimension on 16" and 24" centers. By breaking a 48" x 96" board along the score marks, it is easily converted to two 24" x 96" or three 16" x 96" boards on the job site.



## Physical Properties

Property	Value	ASTM Method
Thermal Resistance, Aged R-Value per in. @ 75°F Mean Temperature (1)	5.0 °F•ft <sup>2</sup> •h/Btu	C 518
Compressive Strength, min. (2)	25 lb/in. <sup>2</sup>	D 1621
Flexural Strength, min.	50 lb/in. <sup>2</sup>	C 203
Water Absorption, max.	0.1 % by vol.	C 272
Water Vapor Permeance (3)	1.1 perms	E 96
Dimensional Stability, max. (% linear change)	2.0	D 2126
Coefficient of Linear Thermal Expansion	3.5x10 <sup>-5</sup> in./in.°F	—
Complies with ASTM C 578 Type	IV	—
Maximum Use Temperature	165°F	—
Flame Spread (4)	5	E 84
Smoke Development (4)	165	E 84

### Notes

- (1) Values are consistent with the criteria of ASTM C 578 and the requirements of the FTC R-value rule (16 CFR Part 460). *R* means resistance to heat flow. The higher the R-value, the greater the insulating power is. Ask your seller for the fact sheet on R-value.
- (2) Vertical compressive strength is measured at 10% deformation or at yield, whichever occurs first. Since STYROFOAM brand insulations are visco-elastic materials, adequate design safety factors should be used to prevent long-term creep. For static loads, 3:1 is suggested. For dynamic loads, 5:1 is suggested.
- (3) Water vapor permeance values at 1" thickness.
- (4) This numerical flame spread rating is not intended to reflect hazards presented by this or any other material under actual fire conditions.

NOTICE: No freedom from any patent owned by Dow or others is to be inferred. Because use conditions and applicable laws may differ from one location to another and may change with time, Customer is responsible for determining whether products and the information in this document are appropriate for Customer's use and for ensuring that Customer's workplace and disposal practices are in compliance with applicable laws and other government enactments. Dow assumes no obligation or liability for the information in this document. NO WARRANTIES ARE GIVEN; ALL IMPLIED WARRANTIES OF MERCHANTABILITY OR FITNESS FOR A PARTICULAR PURPOSE ARE EXPRESSLY EXCLUDED.

COMBUSTIBLE: Protect from flame and other high heat sources. For more information, consult MSDS and/or call Dow (1-800-441-4369). In an emergency, call (1-989-636-4400). Local building codes may require a protective or thermal barrier. Contact your local building inspector for more information.

Published October 2000.



**For Technical Information:**  
**1-800-441-4DOW (4369)**

**The Dow Chemical Company**  
Construction Materials Group  
200 Larkin Center  
Midland, MI 48674

**For Sales Information:**  
**1-800-232-2436**

Visit our website: [dowbuildingmaterials.com](http://dowbuildingmaterials.com)

