

Stabox® | rebar connection system with special coating

Steel reinforcement with guaranteed rebendability used for sealing of working joints must conform to minimum requirements.

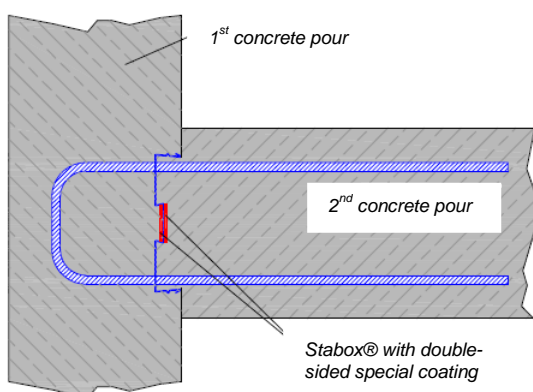

System Diagram

The double-sided special coating of the Stabox® rebar connection system fully complies with these requirements.

The two-side special coating in the middle of the dovetail profile guarantees optimum adhesion between steel plate and concrete, thus avoiding lateral water penetration in both concrete pours.

The double sided special coating is covered by a protective film. Remove protective film prior to concreting!



The Stabox® special coating can be applied to all types of Stabox® stirrup versions together with special Stabox® versions with a dovetail profile. Please let us know the desired type of Stabox® together with your order and add the remark **“with special coating”**.

Important note: Requirements in conformity with water authority guideline

In case the working joint must conform to the requirements of the water authority guideline, for primary sealing, use of the Frank rebar connection system Stabox® type SD (sledge type) combined with an Intec injection hose or a Frank expanding water stop is obligatory.