

Reinforcing Bar Supports

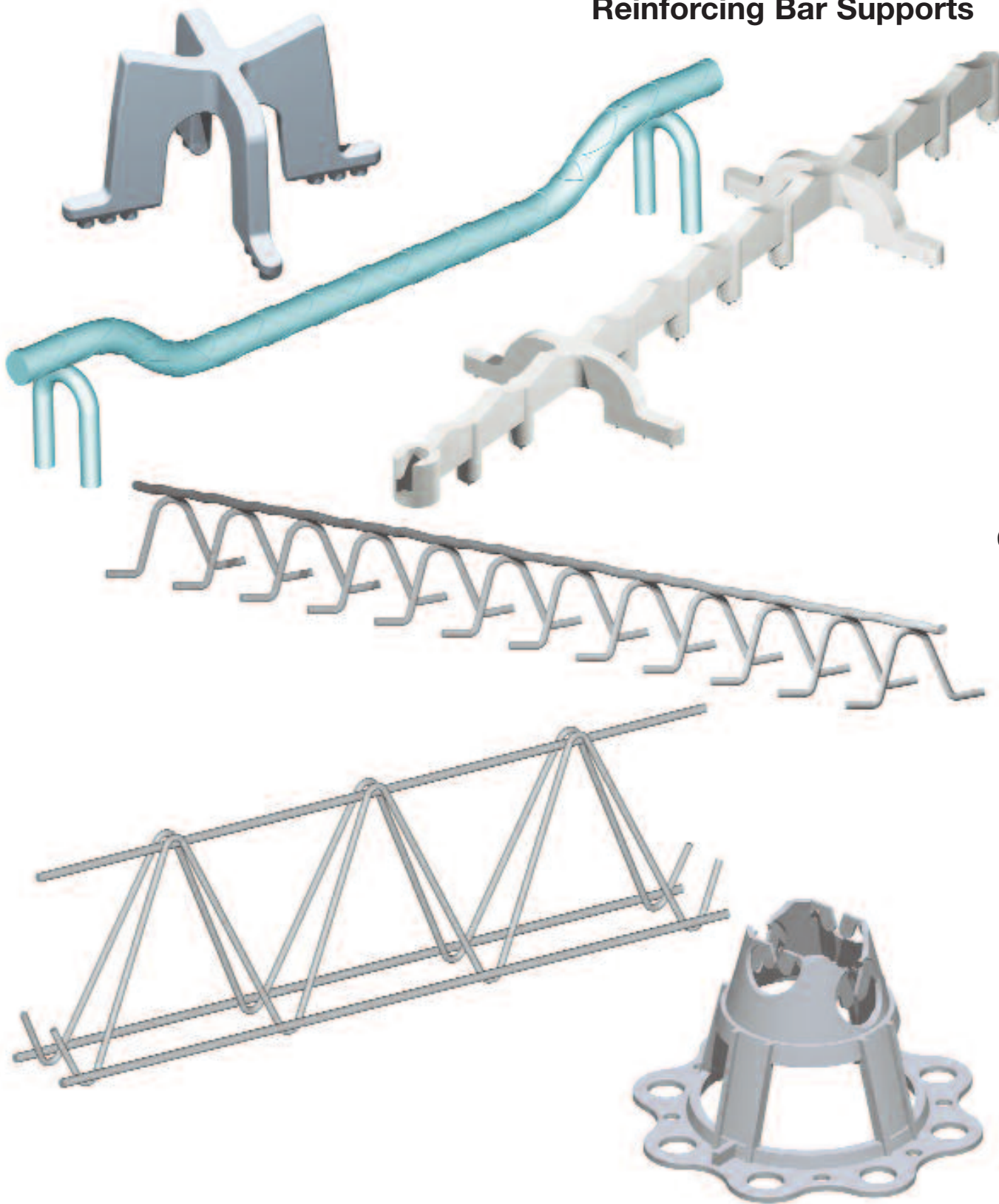

67

67 - 74

Metal Reinforcing Bar Supports

Meadow Burke metal reinforcing bar supports (rebar supports) are manufactured in compliance with Concrete Reinforcing Steel Institute (CRSI) recommendations and comply with American Concrete Institute (ACI) ACI-SP-66, ACI-315 and ACI-315R.

Quality rebar metal supports are available in the following CRSI classifications for finishes:

- Class 1 – Plastic protected, dipped or tipped.
- Class 2A – Stainless steel protected, 1/4" stainless steel tipped.
- Class 2B – Stainless steel protected, 3/4" minimum stainless steel tipped.
- Class 3 – Plain wire, no protection.

Also available:

- Epoxy coated meeting AASHTO specifications.
- Complete plastic coating (100% encapsulate) up to 3" heights.
- Epoxy coated with plastic dipped feet.

Notes:

- Hot dip galvanizing is no longer a CRSI recommended process.
- Stainless steel utilized by Meadow Burke in the manufacture of rebar supports conforms to ASTM A-493 and AISI Type 430 and may display some magnetic qualities which shall not be cause for rejection. Heights available in 1/4" increments.

68

METAL REINFORCING BAR SUPPORTS

(5001) (SB) SLAB BOLSTER

SLAB BOLSTER DATA			
Type	Available Height	Leg Spacing (c/c)	Length
SB	3/4" to 3"	5"	5'-0"

To Order, Specify: quantity, type, height and finish classification.

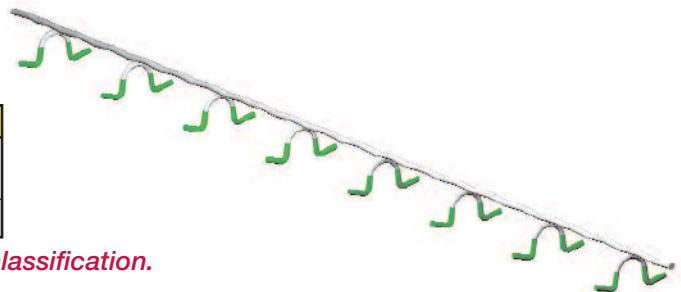

(5005) (SBR) SLAB BOLSTER – UPPER

SLAB BOLSTER - UPPER DATA			
Type	Available Height	Leg Spacing (c/c)	Length
SBR	3/4" to 3"	5"	5'-0"

To Order, Specify: quantity, type, height and finish classification.

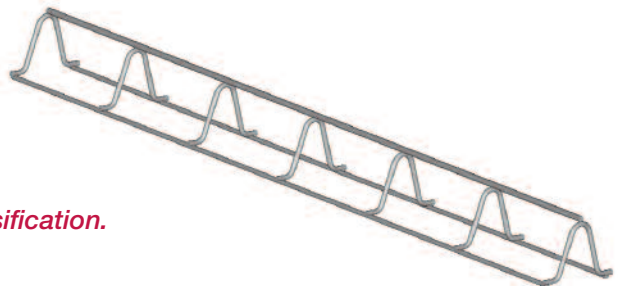

(5015) (BB) BEAM BOLSTER

BEAM BOLSTER DATA			
Type	Available Height	Leg Spacing (c/c)	Length
BB	1" to 5"	2-1/2"	5'-0"

To Order, Specify: quantity, type, height and finish classification.

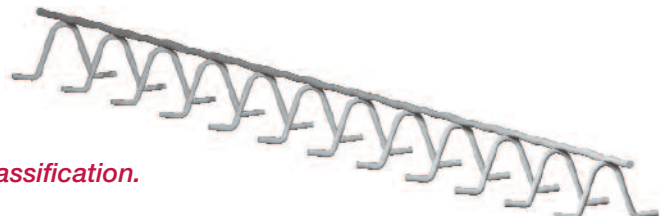

MeadowBurke

Metal Reinforcing Bar Supports

(5025) (UBB) BEAM BOLSTER – UPPER

BEAM BOLSTER - UPPER DATA			
Type	Available Height	Leg Spacing (c/c)	Length
UBB	1" to 5"	2-1/2"	5'-0"

To Order, Specify: quantity, type, height and finish classification.



(5035) (CHC) CONTINUOUS HIGH CHAIR

CONTINUOUS HIGH CHAIR DATA			
Type	Available Height	Leg Spacing (c/c)	Length
CHC	2" to 20"	8"	5'-0"

To Order, Specify: quantity, type, height and finish classification.

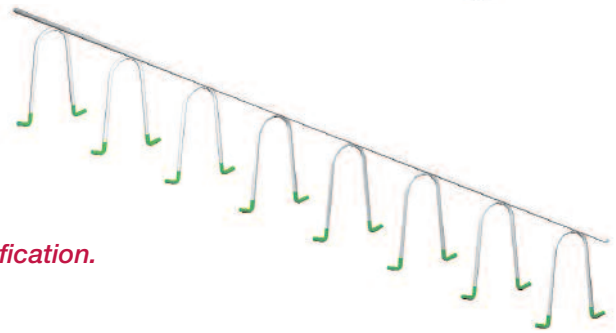

(5040) (UHC) CONTINUOUS HIGH CHAIR – UPPER

CONTINUOUS HIGH CHAIR - UPPER DATA			
Type	Available Height	Leg Spacing (c/c)	Length
UHC	2" to 20"	8"	5'-0"

To Order, Specify: quantity, type, height and finish classification.

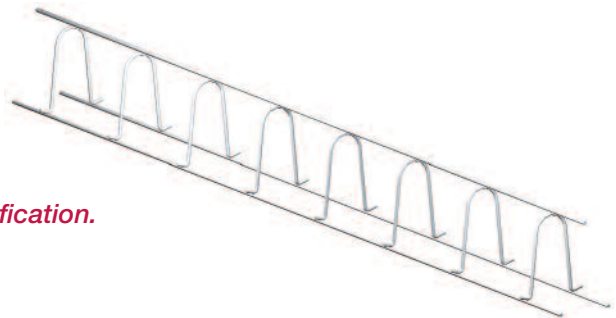

69

(5050) (CHCM) CONTINUOUS HIGH CHAIR – METAL DECK

CONTINUOUS HIGH CHAIR - METAL DECK DATA			
CHCM	Available Height	Leg Spacing (c/c)	Length
Type A	1" to 5"	8"	5'-0"
Type B	1" to 5"	8"	5'-0"

To Order, Specify: quantity, name, type A or B, leg spread, height.

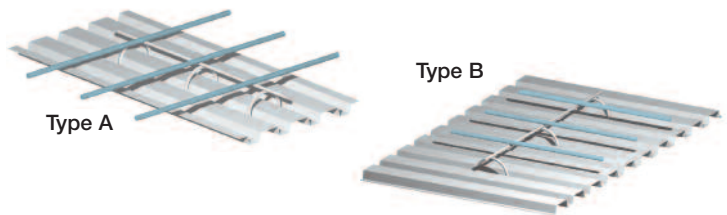

(5100) (HCMD) HIGH CHAIR – METAL DECK

HIGH CHAIR - METAL DECK DATA		
HCMD	Available Height	Height Increments
Type A or B	2" to 15"	1/4"

To Order, Specify: quantity, name, type, A, B and C dimension.

To insure accuracy of order please include metal deck profile.

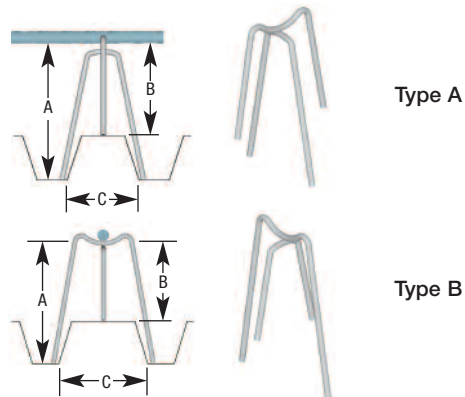

Metal Reinforcing Bar Supports

(5060)(5062)(5065) FC-12, FC-16, FC-20 FOUNDATION CHAIRS

The FC-12, FC-16 and FC-20 Foundation Chairs unique design places maximum support under each rebar providing unmatched strength in other foundation chairs. Correctly spaced cradle points allow quick, correct placement of the reinforcing steel and provide three full inches of concrete cover under and on both sides of the rebar. Foundation Chairs are available for two-rebar and three-rebar foundation applications. Refer to the Table for dimensional data. Foundation chairs are normally spaced on 5'-0" centers. Optional sand plates are available for sandy soil applications.

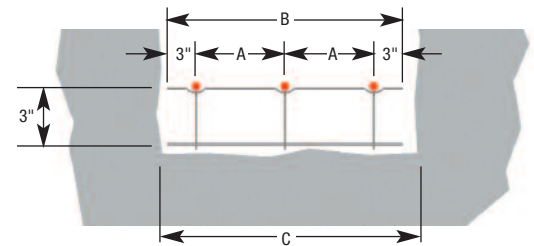
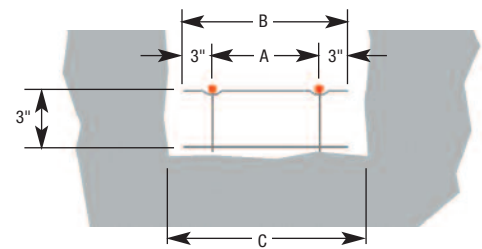
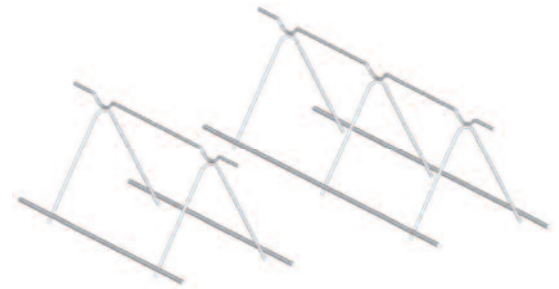

FC-12, FC-16 & FC-20 FOUNDATION CHAIR DATA					
Type	Size	Number of Rebar	"A" Rebar Spacing	"B" Chair Width	"C" Footing Width
FC-12	2-12	2	6"	8-1/2"	12"
FC-16	3-16	3	5"	13-1/4"	16"
FC-20	3-20	3	7"	17-1/2"	20"

70

To Order, Specify: quantity, type, number of rebar, length and finish.

(5075) (HC) HIGH CHAIR

HIGH CHAIR DATA		
Type	Available Height	Height Increments
HC	2" to 40"	1/4"

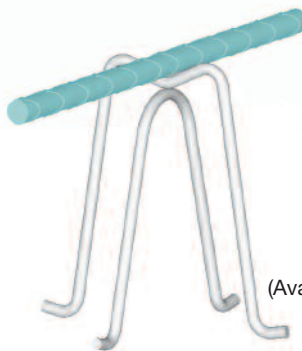

(Available with metal or plastic sand plate)

To Order, Specify: quantity, type, height and finish classification.

(5105) (BC) BAR CHAIR

BAR CHAIR DATA		
Type	Available Height	Height Increments
BC	3/4" to 2"	1/4"

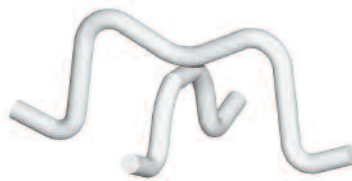

To Order, Specify: quantity, type, height and finish classification.

(5115) (JC) JOIST CHAIR

JOIST CHAIR DATA		
Type	Available Height	Height Increments
JC	3/4" to 2"	1/4"



To Order, Specify: quantity, type, height and finish classification.

(5125) (UJC) JOIST CHAIR – UPPER

JOIST CHAIR - UPPER DATA		
Type	Available Height	SPAN
UJC	-1" to +3-1/2"	14"

To Order, Specify: quantity, type, height and finish classification.

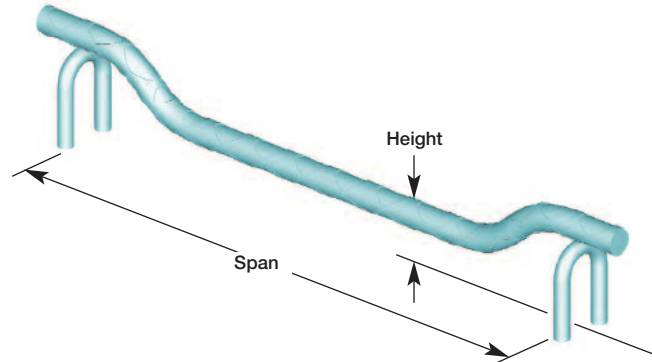

(5150) (CS) CONTINUOUS SUPPORT (ZIG-ZAG)

CS Continuous Support (Zig-Zag) is a steel support for horizontal wire mesh, structural fabric or reinforcing bars and an excellent spacer for vertical steel in concrete walls. The support is very stable, it will not slide or tip and has excellent load carrying capacity. It is easy to install and can be bent around voids and/or partitions.

CONTINUOUS SUPPORT (ZIG-ZAG) DATA			
Type	Available Height	Height Increments	Length
CS	2" to 12"	1/4"	8'-0"

To Order, Specify: quantity, type, height and finish classification.

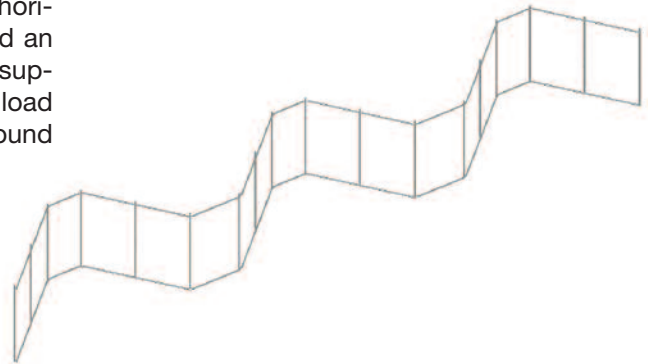

71

(6610) WIRE GIRDER – DOUBLE

The Wire Girder – Double has been designed to quickly and accurately position wire mesh in large slab-on-grade applications. The girder is available in heights from 3" to 9" in 1" increments and in any length up to 40'. Optional snap-on sand plates are available for use on soft, sandy soils and to prevent the girder from turning during concrete placement. When using the girder on a firm casting bed, the snap-on plates are not a necessity but will give better support on slabs exceeding 6" in thickness.

The optional snap-on plates are field installed by simply squeezing the bottom runners of the girder inward until they slip inside the plate tabs. Release of the runners will let them slide under the tabs and be held firmly in place by the tabs.

*To Order Wire Girder - Double, Specify: quantity, type, height and length.
To Order Optional Snap-On Plate, Specify: quantity and type.*

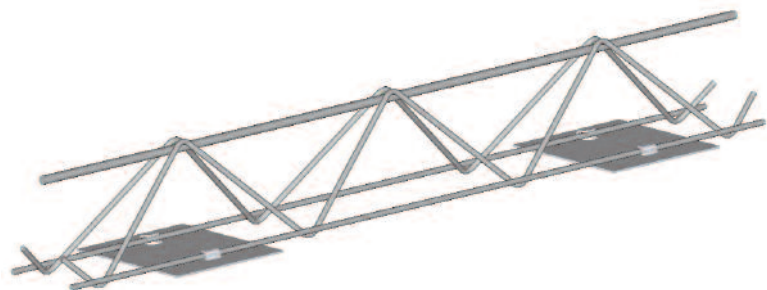

Plastic Reinforcing Bar Supports

(5205) (SBB) SLAB BEAM BOLSTER

The SBB Slab Beam Bolster is fabricated from fiber-filled composite material. They are gray in color to blend with the concrete. The top bar corrugations are on 1" centers to aid rebar placement. It is available in 5' lengths and heights from 3/4" to 4" in 1/4" increments.

To Order, Specify: quantity, type and height.



(5230) (IC) INTERSECTIONAL CHAIR

The IC Intersectional Chair is designed for use at the intersection of two crossing lengths of post tensioning cables rebar to correctly position and firmly hold the two bars in place. The large support base gives added benefit when used on vapor barriers or soft fill. The chair fits 1/2" PT cable or up to #5 rebar, and is available in most heights from 1-1/2" to 7" in 1/2" increments.

To Order, Specify: quantity, type and height.

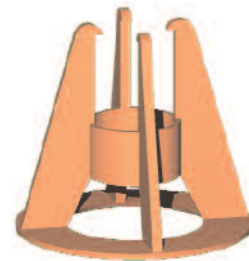

(5235) (MCB) MESH CHAIR WITH BASE

72

The MCB Mesh Chair with Base is a special high chair with sand plate for use on soft surfaces and/or slab on grade to correctly position and hold the wire mesh securely in place. Each size chair is designed to service two mesh positioning heights. It is available in heights from 5/8" to 4". Can support up to #5 rebar crossing over up to #3 rebar.

To Order, Specify: quantity, type and height.



(5240) PC-2 SNAP-ON MESH CHAIR

(5245) PC-3 SNAP-ON MESH CHAIR WITH BASE

The PC-2 and PC-3 Snap-On Mesh Chairs are economical heavy duty, four sided chairs that quickly snap onto 4 ga. to 10 ga. mesh to correctly position it in the slab. The Snap-On Mesh Chair is available in most heights from 3/4" to 3" and the Snap-On Mesh Chair With Base is available in heights from 1-1/2" to 4". Both Chairs will accommodate wire mesh 4 ga. to 10 ga.

To Order, Specify: quantity, type and height.

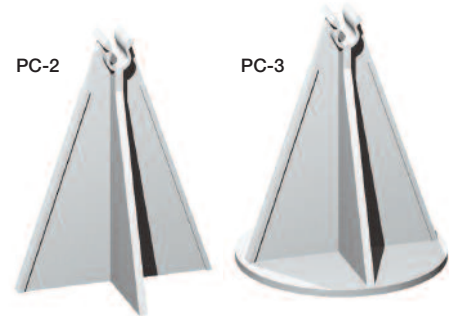

(5250) PC-4 SNAP-ON PAVING CHAIR WITH BASE

(5255) PC-5 SNAP-ON BAR CHAIR

The PC-4 Snap-On Paving Chair and PC-5 Snap-On Bar Chair are substantial plastic bar supports available to support reinforcing steel in various applications. The Snap-On Paving Chair for #3 to #4 rebar or #4 to #6 rebar (PC-4) is available in heights from 3/4" to 7" and the Snap-On Bar Chair for #3 to #7 rebar (PC-5) is available in heights from 3/4" to 3".

To Order, Specify: quantity, type and height.

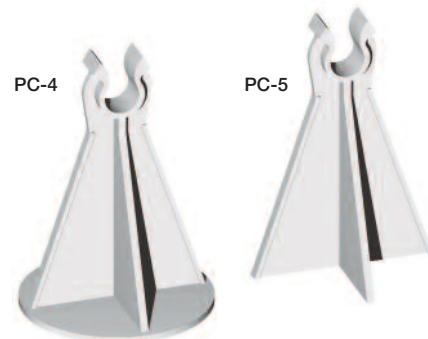

(5265) (PBC) PLASTIC BAR CHAIR

The PBC Plastic Bar Chair is available in heights from 3/4" to 1-3/4" in 1/4" increments.

To Order, Specify: quantity, type and height.



(5300) PW-11 PLASWHEEL

The PW-11 Plaswheel is designed to quickly snap onto and space vertical or horizontal steel at side walls and columns. They are available to accommodate #2 through #8 rebar and provide 5/8" through 4" concrete cover.

To Order, Specify: quantity, type, bar size and cover.

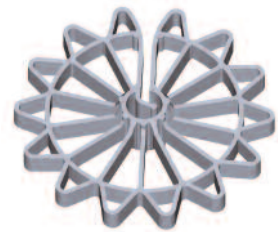

(5305) PW-14 UNISPACER

The PW-14 Unispacer is an economical spacer available in one size to provide a 2" concrete cover. It slides onto any rebar up to #14 size and permits rotation and/or movement of the rebar without risk of the spacer coming off.

To Order, Specify: quantity and type.



73

(5350) BC-2, BC-4 BAR CAP

The BC-2 and BC-4 Bar Cap is available in two sizes for the purpose of protection from scrapes, cuts and torn clothing caused by protruding rebar. It is not intended for use as an impalement protector. The small size BC-2 accepts rebar sizes #3 through #8 and the larger size BC-4 accepts rebar from #9 through #14.

To Order, Specify: quantity, type and rebar size.

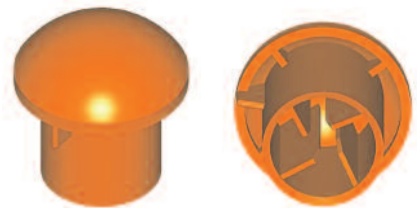

(5355) BC-6, BC-8 REBAR SAFETY CAP

The BC-6 and BC-8 Rebar Safety Cap is an OSHA approved impalement protection safety cap. It is available in two sizes; the smaller size BC-6 accepts rebar sizes #3 through #8 and the larger size BC-8 will accommodate rebar sizes #7 through #12.

To Order, Specify: quantity, type and size.



Concrete Forming Manual

74

