

PRODUCT SUBMITTAL

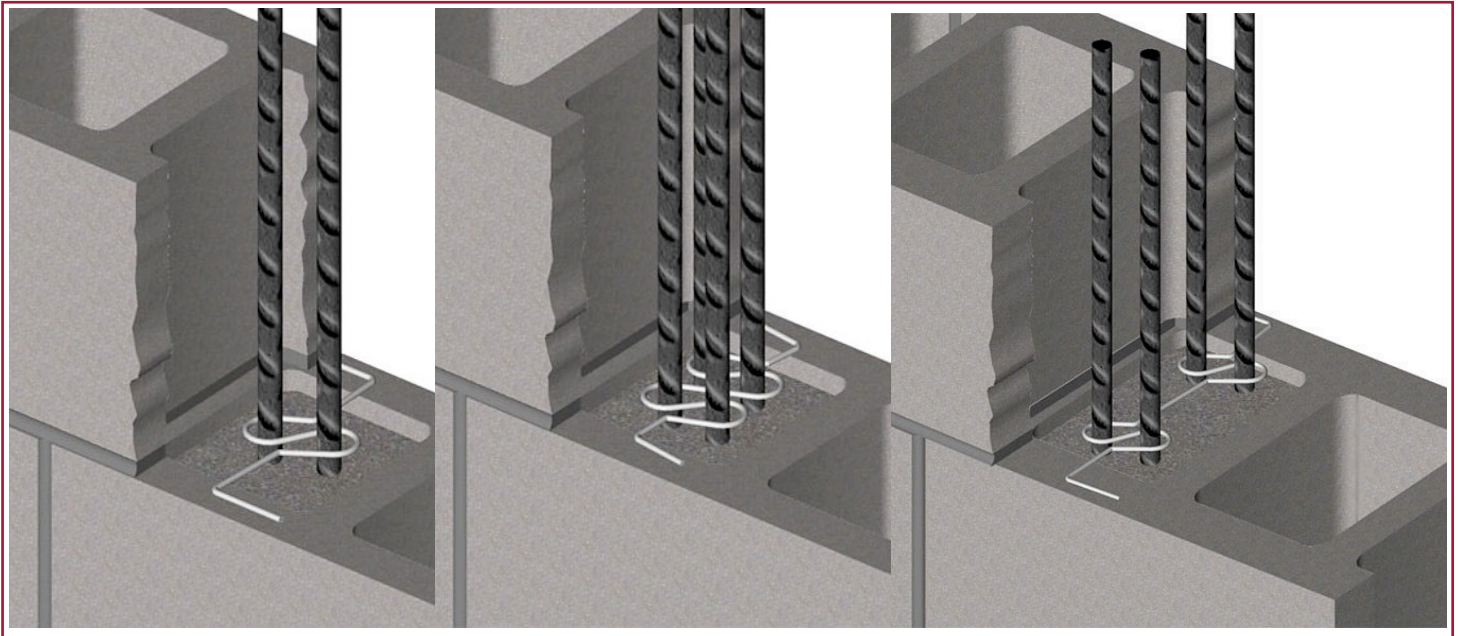

Rebar Positioners Figure 8



3403
Single for
8" CMU

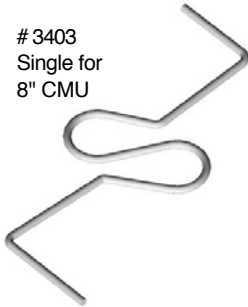

3404
Double for
8" CMU

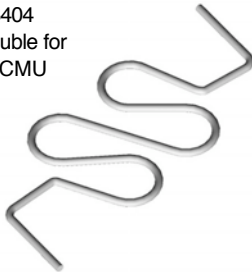

3404
Double for
12" CMU

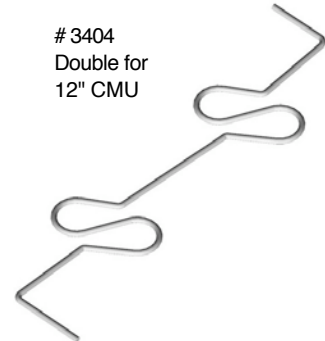

All positioners accept up to # 8 rebar

MATERIAL CONFORMANCE	DESCRIPTION / SIZES / FINISHES
<p>ASTM A82 / A82M - (Cold drawn steel wire) Tensile Strength - 80,000 psi Yield Point - 70,000 psi ASTM A951 / A951M-06 - (Standard Specification for Steel Wire for Masonry Joint Reinforcement) ACI / ASCE 530 - (Building code requirements for masonry structures Mill Galvanized / Zinc Coating: ASTM A641 / A641M (0.10 Oz per sq ft) Hot Dip Galvanized after fabrication / Zinc Coating ASTM A153 / A153M-B2 (1.50 oz per sq ft) Stainless Steel ASTM 580 / ASTM 580M Type 304 (Type 316 available on special order)</p> <p>WIRE Recycled Content: Mill Galvanized & Hot Dip, 85% Post-Consumer 13% Post Industrial / Pre - Consumer Stainless Steel, 60% Post Consumer V O C Content - 0%</p> 	<p>DESCRIPTION: Controls location of rebar, avoiding the edges of the cores of the blocks. Accepts up to # 8 rebar</p> <p>GAUGES: <input type="checkbox"/> 9 GAUGE <input type="checkbox"/> 3/16"Ø</p> <p>SIZES FOR CMU: <input type="checkbox"/> 6" Single <input type="checkbox"/> 8" Single <input type="checkbox"/> 8" Double <input type="checkbox"/> 10" Single <input type="checkbox"/> 10" Double <input type="checkbox"/> 12" Single <input type="checkbox"/> 12" Double</p> <p>FINISH: <input type="checkbox"/> Mill Galvanized <input type="checkbox"/> Hot Dip Galvanized <input type="checkbox"/> Stainless Steel</p>

Corporate Office: 400 Roundtree Rd Charlotte, NC 28217
TEL: (800) 849-6722 FAX: (704) 525-3761

Mailing Address: P.O. Box 240988 Charlotte, NC 28224



www.wirebond.com

Memphis Plant: 2365 Harbor Ave. Memphis, TN 38113
TEL: (800) 441-8359 FAX: (901) 775-9449

Mailing Address: P.O. Box 13124 Memphis, TN 38113